

AGA93.1

Product Description

AGA93.1 is a bracket kit for mounting any VKG... butterfly valve to an SQM33, SQM40, or SQM45 actuator. This kit is only to be used on actuator versions with a 10mm "D" shaft.

Components Supplied

Figure 1 shows the components supplied with the AGA93.1 bracket kit:

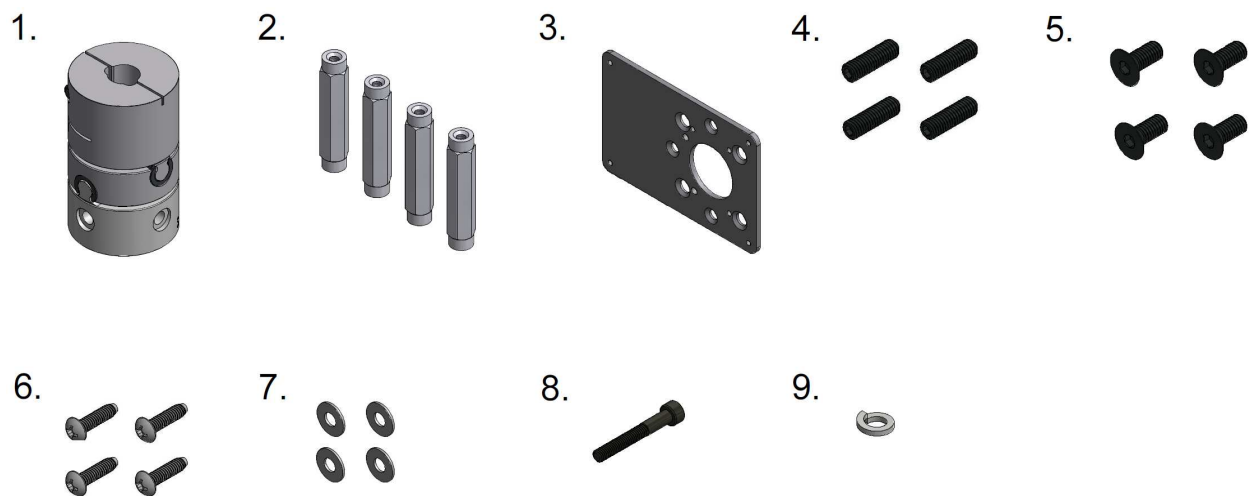

Figure 1: Pieces Supplied with the AGA93.1 Bracket Kit

- | | |
|--|---|
| 1. Coupling | 6. (4) #8-32 x 5/8" thread-forming screws |
| 2. (4) hex standoffs | 7. (4) #8 flat washers |
| 3. Mounting bracket | 8. M4 x 30mm socket head screw |
| 4. (4) M6 x 22mm socket set screws | 9. M4 split lock washer |
| 5. (4) M6 x 14mm flat socket head screws | |

Recommended Installation Tools

The following tools are recommended for installing the AGA93.1 bracket kit:

- 5/32" hex key
- 3mm hex key
- 4mm hex key
- ½" open end wrench (or crescent wrench)
- Cordless drill
- #2 Phillips screwdriver bit (6" or longer)
- Red Loctite
- Blue Loctite

Installation Procedure

1. Slide the coupling over the VKG... valve shaft and line up one of the holes in the coupling with the threaded hole in the valve shaft. Take care to attach the coupling in the desired orientation, taking notice of how the 10mm "D" shaft of the actuator will mount into the top hub of the coupling. Using a 3mm hex key, the M4 split lock washer, and the M4 x 30mm socket cap screw, fasten the coupling to the valve shaft as shown in Figure 2 below.

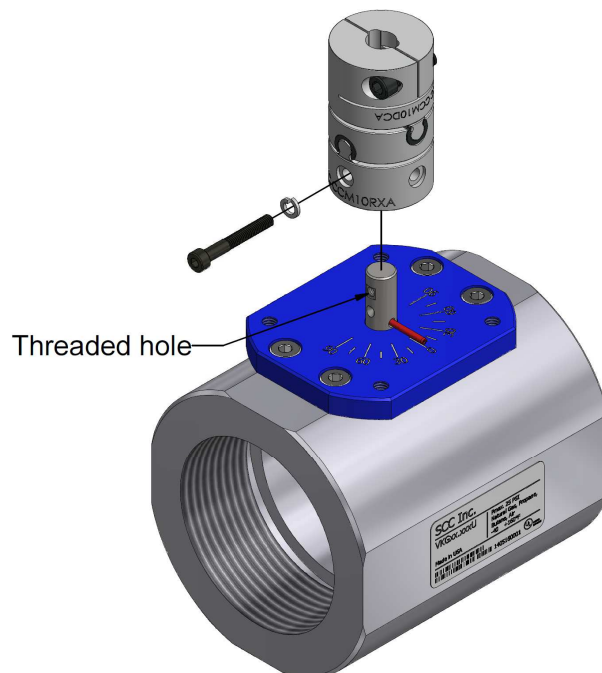

Figure 2: Coupling Installation

- Place a small amount of red Loctite on the end of each of the (4) M6 x 22mm socket set screws. Using a 3mm hex key, fasten each socket set screw into one end of a hex standoff until the screw bottoms out. By hand, thread each standoff into one of the four M6 threaded holes on the top of the blue dial of the VKG... valve as shown in Figure 3. Using the ½" open end wrench (or crescent wrench), tighten each standoff against the dial.

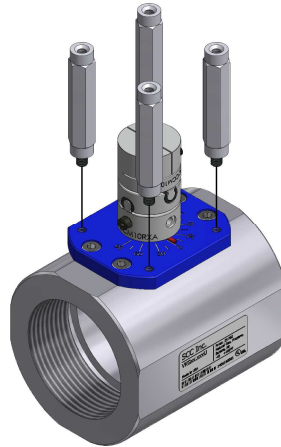

Figure 3: Standoff Installation

- Place a small amount of blue Loctite on the end of each of the (4) M6 x 14mm flat socket head screws. Using a 4mm hex key, fasten the mounting bracket to the top of the standoffs as shown in Figure 4 below. The overhanging section of the bracket must face away from the flat of the "D"-shaped bore in the coupling as shown.

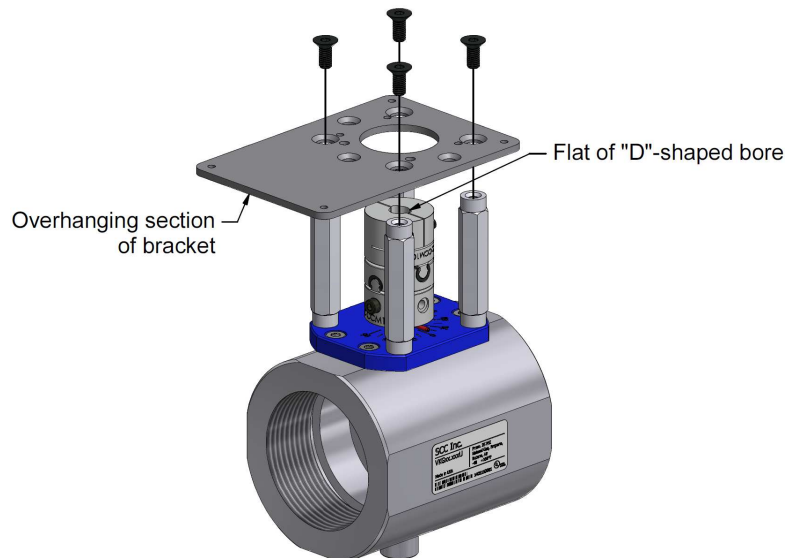

Figure 4: Mounting Bracket Installation

- Place the SQM... actuator shaft into the “D”-shaped bore of the coupling, and line up the four actuator mounting holes with the four corresponding holes in the mounting bracket. Using the cordless drill with the long #2 Phillips bit, the (4) #8-32 x 5/8” thread-forming screws, and the (4) #8 flat washers, secure the actuator to the mounting bracket as shown in Figure 5 below. Take care to ensure the thread-forming screws stay straight when being threaded into the mounting bracket. Then, using a 5/32” hex key, tighten the clamp screw in the top coupling hub to secure the actuator shaft.



Figure 5: Actuator Installation

Information in this publication is based on current specifications. The company reserves the right to make changes in specifications and models as design improvements are introduced. Product or company names mentioned herein may be the trademarks of their respective owners. © 2009 SCC Inc.